

I Latin-American Symposium on Maternal-Fetal Interaction Placenta - Research & Clinical

Embu das Artes, São Paulo – Brazil
2-5 December 2003



The meeting is being held with help from
Sociedade Brasileira de Biologia Celular - SBBC

Sponsored by
Placenta Associations of the Americas - PAA



In cooperation with
IFPA-

**International Federation of
Placenta Associations**



I Latin-American Symposium on Maternal-Fetal Interaction Placenta - Research & Clinical

PROGRAM

| | |
|----------------------------------|----|
| Map of the meeting rooms | 03 |
| Welcome messages | 04 |
| Information to participants..... | 05 |
| Program at a glance | 07 |
| Detailed program | 08 |
| Poster Session | 20 |
| Subjects..... | 20 |
| Author index..... | 32 |

MAP OF THE MEETING ROOMS

Centro de Convenções Azaléia

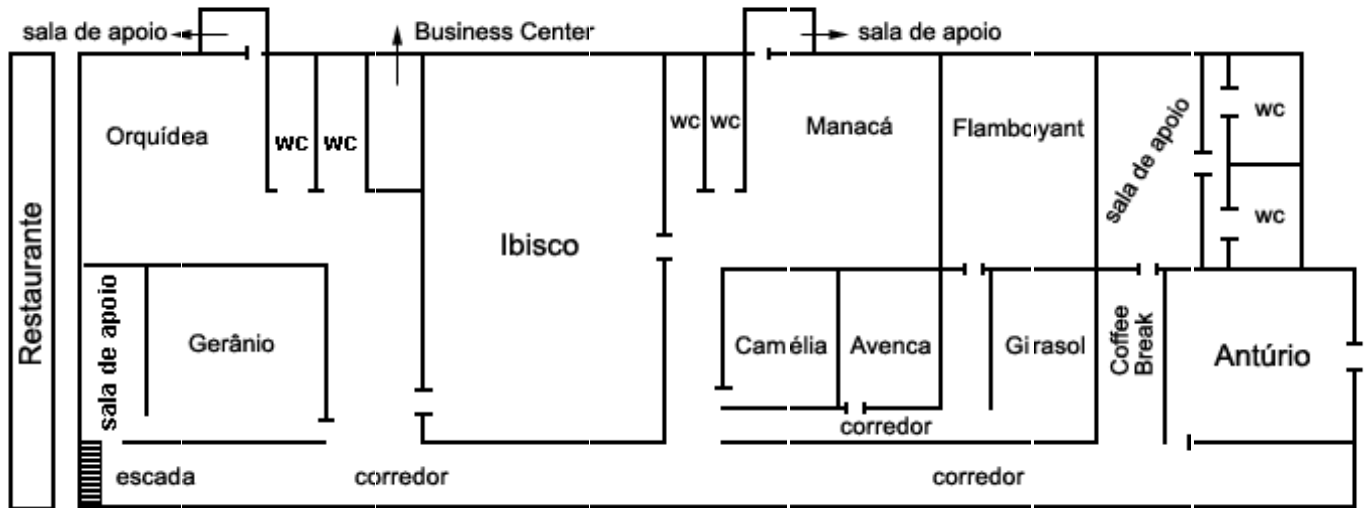

WELCOME MESSAGES



I am very proud and happy to welcome you at Embú das Artes on occasion of the 1st Latin-American Meeting on Maternal-Fetal Interaction with emphasis on the Placenta. There are many reasons for this. For the first time in the Latin America an event is bringing together specialists involved in basic and clinical research on placenta, as well as those involved in diagnosis and therapeutic procedures related to biological and pathological phenomena of the maternal-fetal interaction. On the other hand, life sciences are in the midst of a scientific revolution, where the rapidity of scientific-technological advance and the multidisciplinary nature of current research demand continuing interaction and integration between professionals. Each and every one of us lives today in a privileged time, but is also being challenged to stay updated, to get funds, to publish in an indexed and high impact journal and to insert the research within a social and relevant context. Participation in scientific discussions and exchange of knowledge through round tables, oral presentations, posters and workshops involving frontier themes of general interest is, therefore, vital for our survival. We are almost 200 participants in this first meeting, from different Institutions, countries, and with different expertise. The scope of the meeting embraces the different aspects, which affect or are affected by the placenta, all fundamental for pregnancy and the fetus. I would like to take this opportunity to thank all the authors and scientific participants for their immensely valuable contributions. Every effort is being made in the planning and organization to make the meeting enjoyable as well as professionally successful. I sincerely apologize, however, if I was unable to completely attend all expectations. My deep thanks are also extended to the organizing and scientific committees, whose members, even being from different parts of the world, did not save efforts to help. I also would like to thank the precious support of the Placenta Associations of the Americas and the Brazilian Society for Cell Biology and the cooperation of the International Federation of the Placenta Associations. I am also very pleased to recognize the generous support of the Brazilian Research Financial Agencies, FINEP, CAPES and FAPESP, as well as of the Universidade Estadual de Campinas, the Universidade Estadual Paulista, the Institute of Biomedical Sciences of the Universidade de São Paulo and several scientific companies. I hope this meeting will be an excellent opportunity to share knowledge and to increase interactions in a cordial and friendly atmosphere and, finally, a good reason to be continued.

To all of you, once again, my cordial welcome,

Estela Bevilacqua

Message from IFPA-International Federation of Placenta Associations



The mission of the International Federation of Placenta Associations is to support and promote excellence in the field of placenta research throughout the world. With that in mind we are pleased to offer our cooperation and assistance to the organizers and delegates of the "Latin-American Symposium on Maternal-Fetal Interaction: Placenta - Research and Clinical" meeting in Sao Paulo, Brazil to help make this an outstanding meeting and develop the growth of placental science in Latin America. We wish everyone a successful and productive meeting.

INFORMATION TO PARTICIPANTS

Organizing Committees

Executive Local Committee

Estela Bevilacqua, Áureo Yamada, Ricardo Barini, Marilza V. C. Rudge, Sérgio Ferreira de Oliveira, Paulo A. Abrahamsohn, Maria Ophélia Araújo Galvão, Maria Angélica Miglino, Sonia Gagioti, Andrea Amarante, Mara Hoshida e Alex Vidsiúñas.

Latin American Advisory Committee

Cristina Ibarra, Gabriela Gutierrez, Susana Genti-Raimondi (Argentina), Glória Riquelme (Chile), Angela Cadavid (Colômbia), Margarita Levarios (México), Begoña Campos (México-EUA), Luis V. Marocho Olivera (Peru), Marlene Carneiro (Venezuela)

Secretariat and Slide Desk

Ms. Mara Hoshida, Sonia Gagioti and Adriana Fraga

Certificate of attendance and receipt of registration fees will be provided for all registered participants. If you do not find yours together with your Meeting material, please contact the secretariat.

Plenary Sessions and Round tables

Please deliver your slides/CD ROM for power point presentation at least 15 min prior to the start of your session (see room number in the program) and collect them in the same place after the session. Slide trays will be available.

Poster Session

Instructions for poster presentations

All posters must be placed on the assigned board between 8:00 and 14:00 h on December 3, and should remain in place until the session ends on December 4, 22:30 h. Authors must stay at their posters between 20:30 and 22:30 h for presentation. There will be no major competing scientific symposia during poster presentation. The poster board surface area is 90 cm high by 90 cm by wide. A label will put on the top of the poster indicating the assigned program number of the abstract.

Awards

The posters will be analyzed by a group of scientists. Awards will be presented to the best posters (aspects to be considered: hypothesis; experimental design; results; statistical analysis; conclusions and presentation) during the closing ceremony.

Sponsors

The organizers of the I-SLIMP are pleased to recognize the generous support of:



PROGRAM *at a glance*

| | December 2 | December 3 | December 4 | December 5 |
|--------------|------------------------------------|--|---|--|
| 08h00-08h45 | | Registration | Registration | |
| 08h45- 09h45 | | Lecture #2 Room Ibisco | Lecture # 3 Room Ibisco | Lecture # 4 Room Ibisco |
| 09h45-10h15 | | Coffee break | | |
| 10h15-12h15 | | Round Table # 1 Room Orquídea | Round Table # 10 Room Gerânio | Round Table # 14 Room Orquídea |
| | | Round Table # 2 Room Gerânio | Round Table # 11 Room Antúrio | Round Table # 15 Room Gerânio |
| | | Round Table # 3 Room Antúrio | | Round Table # 16 Room Antúrio |
| 12h15 | | | | Closure / awards presentations |
| 12h15-13h45 | | Lunch | | |
| 14h00-16h00 | | Round Table # 4 Room Orquídea | Round Table # 12 Room Orquídea | |
| | | Round Table # 5 Room Gerânio | Round Table # 13 Room Antúrio | |
| | | Round Table # 6 Room Antúrio | | |
| 16h00-16h30 | | | Coffee break | |
| 16h30-18h30 | Registration | Round Table # 7 Room Gerânio | 16h30-17h00 Technical Lecture # 1 Room Orquídea | |
| | | Round Table # 8 Room Orquídea | 17h00-17h30 Technical Lecture # 2 Room Gerânio | |
| | | Round Table # 9 Room Antúrio | 17h30-18h30 | |
| 18h30-19h00 | Opening Ceremony Room Ibisco | 18h30-20h00 Room Ibisco ••Placenta | Unattended Poster Session Room Ibisco | Award Committee Meeting Room Antúrio |
| 19h00-20h30 | Lecture #1 Room Ibisco | Associations of the Américas ••Latin American Placenta Group? ••Immunology of Reproduction Latin American Group? | Dinner | |
| 20h30-22h30 | Welcome Dinner | Dinner | Attended Poster Session Commercial Exhibition Room Ibisco | |

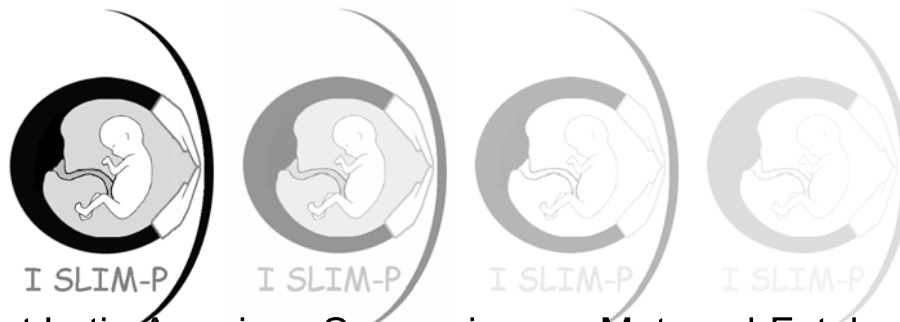

1st Latin American Symposium on Maternal-Fetal
Interaction: Placenta-Clinical and Research

PROGRAM

December 2

16h00-18h30 Registration

18h45-19h10 Opening Ceremony

19h10-20h00 **Lecture # 1:** Convergence in placental structure in divergent groups of mammals
Allen C. Enders
Department of Cell Biology and Human Anatomy, University of California, Davis, USA

20h00-22h30 Welcome Dinner

December 3

08h00-08h45 Registration

08h45-09h45 **Lecture #2:** Regulatory molecules at maternal-fetal interface
Joan Hunt
University of Kansas Medical Center, Kansas City, KS, USA

09h45-10h15 Coffee break

10h15-12h15 **Round Table # 1 – Placental transport-I**

Chairpersons: Nicholas Illsley - New Jersey Medical School, NJ, USA
Fulgencio Proverbio - Inst Venezuelano Investigaciones Científicas, Venezuela

Stacy Zamudio
University of Medicine and Dentistry of New Jersey, New Jersey Medical School, NJ, USA
Placental membrane transport proteins in chronic hypoxia (high altitude residence)

Nicholas Illsley
University of Medicine and Dentistry of New Jersey, New Jersey Medical School, NJ, USA

Regulation of transplacental glucose transport by the polarized distribution of the GLUT1 transporter

Fulgencio Proverbio

Instituto Venezolano de Investigaciones Científicas, Caracas, Venezuela
Ca-ATPase activity and level of lipid peroxidation in different tissues of preeclamptic women

Alicia Damiano

Facultad de Medicina, Universidad de Buenos Aires, Buenos Aires, Argentina
Urea transport in normal and preeclamptic placentas

Guest from poster session:

Gustavo A. Timpanaro

Laboratorio de Canales Iónicos, Facultades de Farmacia y Bioquímica y de Medicina, Universidad de Buenos Aires, Argentina
Calcium transport and self-inhibition by polycystin-2 in human syncytiotrophoblast

10h15-12h15 Round Table # 2 – Fetal loss-associated factors

Chairpersons: **Adriana Sarto** - Halitus Instituto Medico, Buenos Aires, Argentina
Marilza Vieira C. Rudge - Universidade Estadual Paulista, SP, Brasil

Adriana Sarto

Halitus Instituto Medico, Buenos Aires, Argentina
The role of the heparin to prevent the pregnancy loss and the late placental vascular complications in women with thrombophilia

Egle Couto

Centro de Atenção a Saúde da Mulher – Universidade Estadual de Campinas, SP, Brasil
Inherited and acquired thrombophilia in pregnancy

Gabriela Gutierrez

Instituto de Estudios de la Inmunidad Humoral, Universidad de Buenos Aires, Buenos Aires, Argentina
Protective mechanisms of low molecular weight heparin on early fetal losses

Guests from poster session:

Cleofina Bosco

Facultad de Medicina, Universidad de Chile, Santiago, Chile
Thrombomodulin depletion of the endothelial cells of stem villi arteries correlates with elevated plasma PAI-1/PAI-2 ratio in preeclampsia

Fabio Sgarbosa

Faculdade de Medicina de Botucatu, Universidade Estadual Paulista, SP, Brasil
Apoptosis and Bcl-2 expression in placentas of diabetic and hyperglycemic women

Antonio F. S. Bezerra

Depto de Patología, UNCISAL, Maceió, AL, Brasil

Correlation between placental and lung structures in Hyaline Membrane Disease using immunohistochemistry and image analysis process

10h15-12h15 Round Table # 3 – Cells and cytokines in reproduction immunology

Chairpersons: **Áureo Yamada** – Universidade Estadual de Campinas, São Paulo, Brasil
Angela Cadavid - Universidad de Antioquia, Medellín, Colombia

Anne Croy

University of Guelph, Guelph, ON, Canada

Lymphocytes at the feto-maternal interface

Angela Cadavid

Universidad de Antioquia, Medellín, Colombia

Experience of the use of alloimmunotherapy in women with recurrent spontaneous abortion

Silvia Daher

Escola Paulista de Medicina, Universidade Federal de São Paulo, SP-SP, Brasil

Cytokines in pathologies of pregnancy

Aureo Yamada

Depto Histologia & Embriologia, IB, Universidade Estadual de Campinas, SP, Brasil

Cytokines related to the mouse uNK functions in the pregnancy

Guests from poster session:

Marcia Bizinotto

Departamento de Histologia e Embriologia, Instituto de Biologia, Universidade Estadual de Campinas, Campinas, SP, Brasil

Identification of mouse uterine NK cells specific molecules

Julio Bueno

Facultad de Medicina, Universidad de Antioquia, Medellín, Colombia

Effects of glycosaminoglycans on NK and T cell populations in murine pregnancy

12h15-13h45 Lunch

14h00-16h00 Round Table # 4 – Preeclampsia and other pregnancy diseases

Chairpersons: **Glória Riquelme** – Universidad de Chile, Chile
Begoña Campos - University of Cincinnati, USA

Glória Riquelme

Facultad de Medicina, Universidad de Chile, Santiago, Chile

Activity of the transport across ionic channels in trophoblast from normal and preeclamptic placentas

Lesllie Myatt

College of Medicine, University of Cincinnati, Cincinnati, OH, USA
Oxidative Stress in the placenta

Begoña Campos

College of Medicine, University of Cincinnati, Cincinnati, OH, USA
Role of lipidic particles and anti-lipidic particle antibodies in preeclampsia

Luis Sobrevia

Facultad de Medicina, Pontificia Universidad Catolica de Chile, Chile
Alteration of foetal endothelial function in pregnancy-associated diseases

Guest from poster session:

Paola Casanello

Facultad de Medicina, Universidad de Concepcion, Santiago, Chile
Endothelial dysfunction in umbilical vein endothelial cells from foetus with intrauterine growth restriction is related to chronic hypoxia

14h00-16h00 Round Table # 5 – Comparative placentation I

Chairperson: **Maria Angélica Miglino** – Universidade de São Paulo, Brasil

Flávia Thomaz Verechia

Faculdade de Medicina Veterinária e Zootecnia, Universidade de São Paulo, SP, Brasil
Placentation in cloned cattle: microvascular architecture and structure

Antonio Chaves de Assis Neto

Faculdade de Medicina Veterinária e Zootecnia, Universidade de São Paulo, SP, Brasil
Development, structure and ultrastructure of the yolk sac of normal bovine embryo and in cloned, IVF, chimeras, stroncio and parthenogenetic embryos

Felipe Camargo Braga

Faculdade de Medicina Veterinária e Zootecnia, Universidade de São Paulo, SP, Brasil
Non-classical MHC class I in water buffalo placenta

José Roberto Kfoury Jr.

Faculdade de Medicina Veterinária e Zootecnia, Universidade de São Paulo, SP, Brasil

Paula Papa

Faculdade de Medicina Veterinária e Zootecnia, Universidade de São Paulo, SP, Brasil

Francisco Xavier Blasquez

Faculdade de Medicina Veterinária e Zootecnia, Universidade de São Paulo, SP, Brasil

Ana Flávia de Carvalho

Faculdade de Medicina Veterinária de São João da Boa Vista, SP, Brasil

14h00-16h00 Round Table # 6 – Regulatory molecules and the biology of the trophoblast

Chairpersons: **Estela Bevilacqua** – Universidade de São Paulo, Brasil
Joan Hunt - University of Kansas Medical Center, USA

Joan Hunt

The University of Kansas Medical Center, Kansas, USA

Trophoblast-maternal interactions

Estela Bevilacqua

Instituto de Ciências Biomédicas, Universidade de São Paulo, SP, Brasil

Trophoblast phagocytosis: only for histotrophic functions?

Gabriela Gutierrez

Instituto de Estudios de la Inmunidad Humoral, Universidad de Buenos Aires, Buenos Aires, Argentina

Multiparity increased the production of factors that prevents abortion in mice

Sima G. Katz

Escola Paulista de Medicina, Universidade Federal de São Paulo, SP, Brasil

Spatial arrangement of cytokeratin and vimentin filaments in mid-pregnancy mice trophoblastic giant cells

Adriana Vivas

Facultad de Agronomía y Veterinaria, Universidad Nacional de Río Cuarto, Córdoba, Argentina

Growth factors studies in pig pregnancy

Guests from poster session:

Ana Franchi & Maria Laura Ribeiro

Laboratorio de Fisiopatología de la Preñez y el Parto, Centro de Estudios Farmacológicos y Botánicos – CONICET, Argentina

Role of epidermal growth factor on the modulation of cyclooxygenase and nitric oxide synthase enzymes in the placenta

Elida Gonzalez

Laboratorio de Reproducción y Metabolismo - Centro de Estudios Farmacológicos y Botánicos – CONICET, Argentina

Levels of PPAR γ activator 15 deoxy delta^{12,14} prostaglandin J₂ (15dPGJ₂) and its effect on nitric oxide production in placenta from healthy and diabetic patients

16h00-16h30 Coffee break

16h30-18h30 Round Table # 7 – Mechanisms of placental infection

Chairpersons: **Maria Ophélia G Araújo** – Universidade Católica de Brasília, Brasil
Achilea Bitencourt - Universidade Federal da Bahia, Brasil

Achilea Bitencourt

Serviço de Anatomia Patológica, Universidade Federal da Bahia, Salvador, BA, Brasil

Chagasic placentitis

Ricardo Drut

Servicio de Patología, Hospital de Niños - La Plata, Argentina
Villitis of undetermined causes: immunohistochemical studies

Eloísa Amália Vieira Ferro

Universidade Federal de Uberlândia, Uberlândia, MG, Brasil
Kinetics of Toxoplasma gondii infection on trophoblast cell population in Calomys callosus: a model of congenital toxoplasmosis

Maria Ophélia G Araújo

Universidade Católica de Brasília, Brasília, DF, Brasil
Placental morphology associated to Malaria infection: light and electron microscopy and immunohistochemical studies

Guests from poster session:

Priscila Juliano

Faculdade de Ciências Médicas – Universidade Estadual de Campinas, SP, Brasil
The trophoblast barrier is important on modulation of villitis caused by parasites

Regina Schultz

Divisão de Anatomia Patológica e LIM 14, Hospital das Clínicas, Faculdade de Medicina da Universidade de São Paulo, São Paulo, SP, Brasil
Chorangioma, chorangiomatosis, chorangiosis and mesenchymal dysplasia of the placenta - An immunohistochemical investigation

16h30-18h30 Round Table # 8 – Regulatory molecules at the materno-fetal interface

Chairpersons: **Gabriela Gutierrez** – Universidad de Buenos Aires, Argentina
Maria Isabel Moraes-Pinto – Universidade Federal de São Paulo, Brasil

Ricardo A. Margni

Universidad Nacional del Sur, Buenos Aires-Argentina
Role of asymmetric IgG blocking antibodies in pregnancy and its synthesis regulation by placental factors

Elida Gonzalez

Laboratorio de Reproducción y Metabolismo - Centro de Estudios Farmacológicos y Botánicos – CONICET, Buenos Aires, Argentina
Metaloproteases and the placenta: Modulatory mechanisms and their alterations in the diabetic pregnancy

Maria Cecilia Sanchez

Facultad de Ciencias Químicas, Universidad Nacional de Córdoba, Córdoba, Argentina
Regulation of the fibrinolytic activity by human alpha macroglobulins during pregnancy

Maria Isabel de Moraes-Pinto

Escola Paulista de Medicina, Universidade Federal de São Paulo, São Paulo, SP, Brasil

Placental antibody transport and immunization strategies

Guest from poster session:

Cathy Vaillancourt

Université de Moncton & Beauséjour Medical Research Institute, Moncton, New Brunswick, Canada

Characterization of melatonin receptor, MT1 and MT2, in human placenta

16h30-18h30 Round Table # 9 - Decidua and decidualization

Chairpersons: **Paulo Abrahamsohn** – Universidade de São Paulo, Brasil

Sérgio Ferreira de Oliveira – Universidade de São Paulo, Brasil

Paulo Abrahamsohn

Instituto de Ciências Biomédicas, Universidade de São Paulo, São Paulo, SP, Brasil

Decidualization in rodents

Sergio Ferreira de Oliveira

Instituto de Ciências Biomédicas - Universidade de São Paulo, SP-Brasil

Morphological study of cultured mouse decidual cells

Fabiano G. Costa

Universidade Bandeirantes – Paraná, Brasil

Primary culture of mouse decidual cells over different substrates

Guests from poster session:

Carlos Miqueloto

Depto Histologia e Embriologia, Universidade de São Paulo, Brasil

Sites of 3H-estradiol binding on uterine tissues in pseudo-pregnant mice

Karin Carbone

Depto Histologia e Embriologia, Universidade de São Paulo, Brasil

Immunolocalization of type I, III and V collagen of the mice uterus from day 6 to 8 of pregnancy

18h30-20h00 Placenta Association of the Americas

Latin American Placenta Group

Sociedade Latino-Americana de Imunologia da Reprodução

20h30

Dinner

December 4

08h00-08h45 Registration

08h45-09h45 Lecture # 3: Contribution of lymphocytes to endometrial preparation for pregnancy

Anne Croy

University of Guelph, Guelph, ON, Canada

09h45-10h15 Coffee break

10h15-12h15 Round Table # 10 – Extracellular matrix & placenta

Chairpersons: **Telma Zorn** – Universidade de São Paulo, Brasil
Luiz Cristovão de Moraes Sobrinho Porto -
Universidade Estadual do Rio de Janeiro, Brasil

Henrique Lenzi

Instituto Oswaldo Cruz-FIOCRUZ, Rio de Janeiro, RJ, Brasil

Placental stroma: composition and tridimensional architectural arrangement

Luiz Cristovão de Moraes Sobrinho Porto

Departamento de Histologia e Embriologia, Universidade Estadual do Rio de Janeiro, Rio de Janeiro, RJ, Brasil

Contractile cells and fibrillin-1 distribution is disturbed in terminal villi of placentae from patients with preeclampsia and systemic lupus erythematosus

Telma Zorn

Instituto de Ciências Biomédicas, Universidade de São Paulo, São Paulo, SP-Brasil

Extracellular matrix and decidualization in rodents

Sebastian San Martin

Facultad de Medicina, Universidad Valparaiso, Valparaiso, Chile

Proteoglycans of the mouse endometrium before and after the embryo implantation. Composition and putative role

Guest from poster session:

Luz Elena Caraveo Borunda & Elizabeth González-Puebla

Facultad de Ciencias Químicas de Chihuahua, México

Immunohistochemistry of metalloproteinase-9 in the placenta of women environmentally exposed to lead

10h15-12h15 Round Table # 11 – Immunology of the gestation - I

Chairperson: **Ricardo Barini** – Universidade Estadual de Campinas, SP, Brasil

Ricardo Barini

Ambulatório de Perdas Gestacionais, Universidade Estadual de Campinas, SP, Brasil

Immune problems in recurrent abortion

Marcelo Cavalcante

Universidade Federal do Ceará, Fortaleza, Brasil

Interleukins balance in the normal gestation, recurrent miscarriages and implantation failures

Marcelo Alvarenga

Depto de Ginecologia e Obstetrícia, Faculdade de Ciências Médicas, Universidade Estadual de Campinas, Campinas, SP, Brasil

Immune pathology analysis of the decidua and placenta in recurrent spontaneous abortion and implantation failure

Guest from poster session:

Renate von Linsingen

Departamento de Genética, Universidade Federal do Paraná, Curitiba, PR, Brasil

Cytokine genes polymorphisms and recurrent spontaneous abortion

Andréa Moraes

Depto Patologia -Escola Paulista de Medicina - Universidade Federal de São Paulo – Brasil

FISH and nested-PCR vs cytogenetic approach in fetal and early spontaneous abortions material: Correlation with pathological findings

12h15-13h45 Lunch

14h00-16h00 Round Table # 12 – Immunology of gestation - II

Chairpersons: **Henrique Lenzi** – Fundação Instituto Oswaldo Cruz, Brasil
Rosanna Ramhorst - Universidad de Buenos Aires, Argentina

Marcelo Pelajo-Machado

Instituto Oswaldo Cruz-FIOCRUZ - Rio de Janeiro, RJ, Brasil

Placenta as a lympho-hemotopoietic organ in mice

Udo Markert

Institute of Gynecology and Obstetric - Universidad Friedrich-Schiller, Jena, Germany

Intracellular JAK/STAT signal transduction at the feto-maternal interface

Rosanna Ramhorst

Facultad de Medicina, Universidad de Buenos Aires, Buenos Aires, Argentina

New insight into the immunological mechanisms involved in the materno-fetal tolerance

14h00-16h00 Round Table # 13 – Comparative placentation II

Chairperson: **Maria Angélica Miglino** - Universidade de São Paulo, Brasil

Tatiana Carlesso dos Santos

Faculdade Medicina Veterinária e Zootecnia, Universidade de São Paulo, SP, Brasil

Microvasculature of the collared peccary placenta

Moacir Franco de Oliveira

Faculdade Medicina Veterinária e Zootecnia, Universidade de São Paulo, SP, Brasil

Placentation in the rock cavy (Kerodon rupestris)

Marina Bonatelli

Faculdade Medicina Veterinária e Zootecnia, Universidade de São Paulo, São Paulo, SP, Brasil

The placenta and subplacenta of the paca Agouti paca

Selma M. de Almeida Santos

Faculdade Medicina Veterinária e Zootecnia, Universidade de São Paulo, SP, Brasil

Placentation in snakes: Crotalus d. terrificus and Bothrops jararaca

Guest from poster session:

Roberto Gameiro de Carvalho

Departamento Cirurgia, Faculdade de Medicina Veterinária e Zootecnia, São Paulo, SP, Brasil

The sub-placenta in capybara (Hydrochaeris hydrochaeris)

Cláudia K Minazaki

Departamento de Histologia & Embriologia, Instituto de Ciências Biomédicas, Universidade de São Paulo, SP, Brasil

Activity and expression of acid phosphatase, cathepsin D, NAD(P)H-oxidase and peroxidase in labyrinth and in marginal hematoma of the term cat placenta

16h00-16h30 Coffee break

16h30-17h00 Technical Lecture #1: Reproduction Cell Biology: micromanipulation, microdissection and cellular injection

Josely Marchi Chiarella

Eppendorf do Brasil Ltda

17h00-17h30 Technical lecture #2: New strategies in molecular biology that can be applied to reproduction studies

Jayme Nunes de Souza Filho

Biobrás Diagnósticos

17h30-18h30 Umattended poster session

Commercial exhibition

Award Committee Meeting

19h00-20h30 Dinner

20h30-22h30 Attended Poster Session

Commercial exhibition

December 5

08h45-09h45 Lecture # 4: Umbilical cord revisited

Ricardo Drut

Servicio de Patología, Hospital de Niños “Superiora Sor María Ludovica”, La Plata, Argentina

09h45-10h15 Coffee break

10h15-12h15 Round Table # 14 –Gene expression in normal & pathological pregnancies

Chairpersons:

Suzana Genti-Raimondi – Universidad Nacional de Córdoba, Argentina

Fernando López Díaz - Universidad Nacional de Córdoba, Argentina

Fernando López Díaz

Facultad de Ciencias Químicas, Universidad Nacional de Córdoba, Córdoba, Argentina

Gene expression and biological function of pregnancy specific glycoproteins

Susana Genti-Raimondi

Departamento de Bioquímica Clínica, Facultad Ciencias Químicas,
Universidad Nacional de Córdoba, Córdoba, Argentina
Differential gene expression in normal and pathological trophoblastic tissues

Guest from poster session:

Annie Duchesne

Université du Québec à Montréal, Canada
*Expression and activity of proteins involved in cholesterol metabolism in
cytotrophoblast and syncytiotrophoblast cells of human term placenta*

Rodrigo Nores

Facultad de Ciencias Químicas Universidad Nacional de Córdoba. Córdoba,
Argentina
*Transcriptional control of the human pregnancy-specific glycoprotein 5 gene
is dependent on two GT-boxes recognized by the ubiquitous specificity
protein 1 (SP1) transcriptional factor*

André L.S. Figueiredo

Universidade Estadual do Rio de Janeiro, RJ, Brasil
*Molecular analyses of expression of ESX 1L gene in different stages of
human placenta development*

Louiza Belkacemi

Université du Québec à Montréal, Montréal, Québec, Canada
*Identification of vitamin D receptor and its upregulation by $1,25(\text{OH})^2\text{D}^3$ before
CABP28K expression upregulation in JEG-3 choriocarcinoma cell line*

10h15-12h15 Round Table # 15 – Comparative placentation II

Chairpersons: **Luis Vicente Marocho Olivera**, Universidad Nacional de
Altiplano, Peru
Luana Paulesu – University of Siena, Italy

Allen C. Enders

Dept of Cell Biology and Anatomy, University of California, Davis, USA
Comparative structure of the yolk sac in eutherian mammals

Luis Vicente Marocho Olivera

Facultad de Medicina Veterinaria y Zootecnia, Universidad Nacional de
Altiplano, Peru
*Trophoblast-endometrial interactions during implantation and placentation in
alpacas*

Carlos Eduardo Ambrósio

Faculdade Medicina Veterinária e Zootecnia, Universidade de São Paulo, SP,
Brasil
The development of the dog placenta: microvasculature and blood flow

Luana Paulesu

Department of Physiology, University of Siena, Siena, Italy
Potential action of IL-1 system in placental viviparity

William Hamlett

Indiana University School of Medicine, Notre Dame, Indiana, USA

Immunoprivileged sites for placentation and sperm storage in a chondrichthyan fish, the smoothhound shark, Mustelus canis

10h15-12h15 Round Table # 16 – Placental transport-II

Chairpersons: **Cristina Ibarra** - Universidad de Buenos Aires, Argentina
Horacio Cantiello - Harvard Medical School, USA

Silvia Gonzalez Perrett

Facultad de Medicina, Universidad de Buenos Aires, Buenos Aires, Argentina
Characterization of K^+ and Ca^{2+} -permeable channels in normal and pathological human placenta

Horacio Cantiello

Massachusetts General Hospital East - Harvard Medical School, Boston, MA, USA
Intracellular regulation of polycystin-2 in human syncytiotrophoblast

Reinaldo Marin

Centro de Biofísica y Bioquímica, Instituto Venezolano de Investigaciones Científicas, Caracas, Venezuela
Effect of placental hypoxia on the Ca-ATPase and lipid peroxidation of syncytiotrophoblast plasma membranes

Cristina Ibarra

Facultades de Farmacia y Bioquímica y de Medicina, Universidad de Buenos Aires, Buenos Aires, Argentina
Aquaglyceroporins in human placenta

Guest from poster session:

Paula Llanos

Facultad de Medicina, Universidad de Chile, Santiago, Chile
Modulation of maxi Cl⁻ channel from human placenta by annexin VI

12h15 Closing Ceremony and awards presentations

13h00 Lunch

P-01

METHODS FOR IN SITU DETECTION OF CELL PROLIFERATION AND APOPTOSIS IN THE PLACENTA OF FEMALE RATS WITH SEVERE DIABETES

Elaine CNF Costa; Luís F Barbisan; Iracema MP Calderon; Marilza VC Rudge, Depto. Ginecologia e Obstetrícia, Faculdade de Medicina de Botucatu, UNESP. Depto de Morfologia, Instituto de Biociências, UNESP, Botucatu.

P-02

APOPTOSIS AND BCL-2 EXPRESSION IN PLACENTAS OF DIABETIC AND DAILY HYPERGLYCEMIC WOMEN

Fabio Sgarbosa, Marilza VC Rudge, Luis Fernando Barbisan, Maria AM Brasil, Elaine CNF Costa. Faculdade de Medicina de Botucatu – UNESP

P-03

IN VITRO TESTING FOR GENOTOXICITY OF THE DIETHYL-PARAOXON IN NEONATES AND ADULTS

Karely Islas¹, Elsa Reyes¹, Monserrat Sordo², Margarita Levario-Carrillo³, Carmen González¹
1Facultad of Chemical Sciences, UA Ch. 2.Institute of Biomedical Investigations, U.N.A.M.
3.Unit Medical Investigation in Clinical Epidemiology, Chihuahua, Mexico.

P-04

CELL DEATH AND CASPASE ACTIVITY IN MOUSE EMBRYOS TREATED WITH TNF- α

Philip Wolff^{1,2}; J. E. Belizário¹ and E. Bevilacqua². Departamento de Farmacologia¹ & Depto Histologia e Embriologia², Instituto de Ciências Biomédicas, Universidade de São Paulo – SP Brasil.

P-05

THE MOUSE IMPLANTING TROPHOBLAST CELLS ARE ABLE TO INDUCE CELL DEATH

Sara Zago Gomes & Estela Bevilacqua. Depto de Histologia e Embriologia, Instituto de Ciências Biomédicas da Universidade de São Paulo, SP, Brasil

P-06

IMMUNO-PRIVILEGE MECHANISMS AND APOPTOSIS AT THE FETO-MATERNAL INTERFACE

Rosanna Ramhorst, Laboratório de Inmunogenética, Hospital de Clínicas “José de San Martín”, Universidad de Buenos Aires, Argentina.

BIOLOGY OF TROPHOBLAST

P-07

PHAGOCYTOSIS AS A POTENTIAL DEFENSE MECHANISM OF THE MOUSE TROPHOBLAST PLACENTAL CELLS

Andréa Amarante-Paffaro¹; Grace S. Queiroz¹; Sabrina T Corrêa¹; Beny Spira² & Estela Bevilacqua¹ - Depts of Microbiology² and Histology & Embryology¹, Univ of São Paulo, SP - Brazil

P-08

EFFECT OF ASPIRIN ON TROPHOBLASTIC DIFFERENTIATION IN THE BeWo CHORIOCARCINOMA MODEL

Claudia Guzmán, Lina Cadavid, Julio Bueno, Beatriz Peña, Fernando Montoya, Angela Cadavid. Reproduction Group, University of Antioquia, AA 1226, Medellín-Colombia.

P-09

DEVELOPMENTAL CHANGES IN THE PLOIDY OF MOUSE IMPLANTING TROPHOBLAST CELLS IN VITRO

Cláudia Regina Gonçalves¹ • Sylvie Antonini² • Angela M. Vianna-Morgante² • Gláucia M M-Santelli¹ • Estela Bevilacqua¹ - ¹Depto de Histologia e Embriologia, Instituto Ciências Biomédicas, ²Depto Biologia, Instituto Biociências, Universidade de São Paulo, Brazil.

P-10

ANTI-MOUSE TROPHOBLAST FAB LIBRARY SELECTION BY IMUNOHISTOCHEMISTRY-LIKE PANNING STRATEGY

Luis AV Cordeiro¹; M Kadirov²; E Bevilacqua¹; P Kaufmann³; H Frank³ ¹Biomedical Science Institute, São Paulo University, Brazil; ²Medical Institute, Ashabad, Turkmenistan; ³School of Medicine, Technical University of Aachen, Germany.

P-11

STUDY OF THE HISTOLOGY OF THE HUMAN AND RAT PLACENTAL BARRIER

Silvia HS Côrtes¹; João CS Côrtes Jr¹; Rachel E Santos¹; Ana L Quinto¹, Roberta C Perosa¹; João CS Côrtes¹, Dept Histology & Embryology. Severino Sombra Univ (USS), Vassouras, RJ, Brazil.

CLINICAL ASPECTS

P-12

INFLUENCES OF DELIVERY ON NUMBER OF LEUKOCYTES AND LYMPHOCYTES SUBSETS IN PERIPHERAL AND UMBILICAL CORD BLOOD

Fernanda Cuello¹, Adriana Vivas² y Cecilia Greco¹ ¹Departament of Immunology and Animal Anatomy, National University of Rio Cuarto. Argentina. Ruta 36 km 601. CP: X5804BYA. Tel/Fax: 54-358-4676210. fcuello@ayv.unrc.edu.ar

P-13

METHOD TO STUDY VOLUME AND ABSOLUTE DENSITY IN TERM HUMAN PLACENTA

Ulisses Del Nero*; Marilza Vieira Cunha Rudge*; Neil Ferreira Novo**; Iracema de Mattos Paranhos Calderon*; Maria Aparecida Mourão Brasil*. *Faculdade de Medicina de Botucatu, UNESP/Departamento Ginecologia e Obstetrícia; **Centro de Ciências Médicas e Biológicas-PUC/SP.

P-14

PROSPECTIVE STUDY OF THE INFLUENCE OF THE MOTHER'S LOW ECONOMIC LEVEL ON THE NEWBORN AND ON THE PHYSICAL CHARACTERISTICS OF THE HUMAN TERM PLACENTA: WEIGHT, VOLUME, AND ABSOLUTE DENSITY

Ulisses Del Nero*; Marilza VC Rudge*; Maria Aparecida Mourão Brasil*; Neil Ferreira Novo**; Roberto Antônio Araújo Costa*; Renato Santiago Pinheiro de Lima*. *Faculdade de Medicina de Botucatu, UNESP; **Centro de Ciências Médicas e Biológicas – PUC/SP

COMPARATIVE PLACENTATION

P-15

ACTIVITY AND EXPRESSION OF ACID PHOSPHATASE, CATHEPSIN D, NAD(P)H-OXIDASE AND PEROXIDASE IN LABYRINTH AND IN MARGINAL HEMATOMA OF THE TERM CAT PLACENTA

Cláudia K Minazaki¹; S Gaglioti²; D Zago²; V Cavalcanti³; FA Genta⁴; W Terra⁴; E Bevilacqua¹. ¹Depto Histologia & Embriologia – USP; ²Depto Histologia – Univ Sto Amaro; ³Disc Patologia Bucal – USP; ⁴Lab Bioquímica de Insetos – USP, Brasil

P-16

TROPHOBLAST SIGNALLING IS WEAKENED IN IN VITRO FERTILIZED (IVF)-DERIVED BOVINE EMBRYOS AFTER CRYOPRESERVATION

Couto, M.C.A.¹; Ramos, A. A.¹; Carvalho, P.H. A.²; Couto, G. P.²; Vale Filho, V. R.¹; Ferreira, A. M.³; Ferreira de Sá, V.³; Camargo, L.S. A.³; Albuquerque, F, T.²; Jôao Bosco Barreto Filho². 1- Universidade Federal de Minas Gerais (UFMG); 2-Universidade Federal de Lavras – (UFLA); 3-Pesquisador, Empresa Brasileira de Pesquisa Agropecuária – CNPGL

P-17

THE SUB-PLACENTA IN CAPYBARA (*HYDROCHAERIS HYDROCHAERIS*).

Roberto Gameiro de Carvalho¹, M Bonatelli¹, MA Miglino¹. 1Departamento de Cirurgia – Faculdade de Medicina Veterinária e Zootecnia, São Paulo – USP

DECIDUA & EXTRACELLULAR MATRIX

P-18

ROLE OF NITRIC OXIDE IN LPS-INDUCED EMBRYONIC RESORPTION

Julieta Aisemberg, Diego Ogando, Maximiliano Cella, Ana Franchi. CEFYBO (CONICET) Argentina

P-19

MESOMETRIAL STROMAL CELL MODIFICATIONS DURING EARLY PREGNANCY IN MICE

Alex K. Vidsiunas* & Sérgio F. Oliveira. Laboratory of Endometrial Biology, Department of Histology and Embriology of University of São Paulo, São Paulo-SP, Brazil.

P-120

SITES OF 3H-ESTRADIOL BINDING ON UTERINE TISSUES IN PSEUDO-PREGNANT MICE

Carlos Miqueloto; C. Pellegrini, M. Soto-Suazo, W.E. Stumpf & T.M.T. Zorn. Laboratório de Biologia da Reprodução e da Matriz Extracelular, Depto Histologia e Embriologia, ICB/USP

P-21

CHARACTERIZATION OF FIBROBLAST-LIKE CELL PLASTICITY IN THE PUBIC SYMPHYSIS OF PREGNANT (SWISS) MICE

Ivan CM. Ferreira¹; SG Moraes¹; MC Pinheiro¹; OM Toledo²; AT Yamada¹; PP Joazeiro¹. 1. Depto de Histologia e Embriologia, Instituto de Biologia, UNICAMP. 2. Depto. Morfologia – Disciplina de Histologia - UNIFESP.

P-22

MORPHOLOGICAL, MORPHOMETRICAL AND HISTOCHEMICAL FEATURES OF THE DECIDUOMA INDUCED BY SEVERAL SUBSTANCES IN PSEUDOPREGNANT MOUSE

Juares ER Bianco; Daniel Favero; Celia GTJ Andrade. Universidade Estadual de Londrina, PR, Brasil

P-23

PROSTAGLANDIN SYNTHESIS IS DIFFERENTLY REGULATED IN UTERUS AND DECIDUA IN A LPS-INDUCED EMBRYONIC RESORPTION MURINE MODEL

Julieta Aisemberg, D Ogando, M Cella, A Franchi. CEFYBO (CONICET) Buenos Aires, Argentina.

P-24

IMMUNOLOCALIZATION OF TYPE I, III AND V COLLAGEN OF THE MICE UTERUS FROM DAY 6 TO 8 OF PREGNANCY

Karin Carbone²; C Pellegrini and TMT Zorn¹. 1-Laboratório de Biologia da Reprodução e da Matriz Extracelular, Depto Histologia e Embriologia, Instituto de Ciências Biomédicas, Universidade de São Paulo, Brasil. 2-Laboratório de Histologia e Embriologia, Depto Morfofisiologia, Univ Santa Catarina, Brasil.

P-25

FOLLISTATIN AND PROLACTIN IN THE MOUSE UTERUS DURING PREGNANCY

Luciane Candeloro; C Pellegrini; TMT Zorn. Laboratorio de Biologia da Reprodução e da Matriz Extracelular, Departamento de Histologia e Embriologia, Instituto de Ciências Biomédicas, USP.

P-26

IMMUNOHISTOCHEMISTRY OF MATRIX METALLOPROTEINASE-9 IN THE PLACENTA OF WOMEN ENVIRONMENTALLY EXPOSED TO LEAD

Luz E. Caraveo-Borunda¹; Elizabeth González-Puebla¹; Ernesto Ramos-Martínez²; Blanca Sánchez-Ramírez¹; Carmen González-Horta¹, Luz H. Sanin³. ¹Lab. Inmunología, Fac. Ciencias Químicas, UACH. Chihuahua, Chih., México. ²Depto. Anatomía Patológica, Hospital Central Universitario Fac. Medicina, UACH. ³Fac. de Enfermería y Nutriología, UACH., Mexico.

P-27

PROTEOGLYCAN OF THE MOUSE ENDOMETRIUM BEFORE AND AFTER THE EMBRYO IMPLANTATION. COMPOSITION AND PUTATIVE ROLE

Sebastian San Martin¹ and Telma Zorn². ¹Facultad de Medicina, Universidad de Valparaiso, Chile. ²Laboratório de Biologia da Reprodução, Departamento de Histologia e Embriologia, Instituto de Ciências Biomédicas, Universidade de São Paulo, Brasil.

GENES AND MOLECULAR BIOLOGY

P-28

MOLECULAR ANALYSES OF EXPRESSION OF ESX1L GENE IN DIFFERENT STAGES OF HUMAN PLACENTA DEVELOPMENT

André LS Figueiredo^{1,2}; Luis CMS Porto²; Laurie Fohn³; Richard Behringer³, Rodolpho M Albano¹. 1-Department of Biochemistry, Rio de Janeiro State University - UERJ. 2- Department of Histology and Embryology, Rio de Janeiro State University - UERJ. 3- Department of Molecular Genetic, University of Texas, M.D. Anderson Cancer Center

P-29

TRANSCRIPTIONAL CONTROL OF THE HUMAN PREGNANCY-SPECIFIC GLYCOPROTEIN 5 GENE IS DEPENDENT ON TWO GT-BOXES RECOGNIZED BY THE UBIQUITOUS SPECIFICITY PROTEIN 1 (SP1) TRANSCRIPTION FACTOR

Rodrigo Nores¹, Loïc Blanchon², Fernando López-Díaz¹, José L. Bocco¹, Luis Patrino¹, Vincent Sapin² & Graciela Panzetta-Dutari¹. ¹Depto. Bioquímica Clínica. Fac. Ciencias Químicas. U.N.C. Córdoba, Argentina. ²Unité INSERM U. 384. France.

MATERNAL-FETAL INTERACTIONS

P-30

EFFECTS OF PRENATAL EXPOSURE TO METHYL PARATHION IN THE PLACENTAL MORPHOLOGY OF THE RAT

Margarita Levario-Carrillo¹, Maria Elena Olave², Dora Chávez², Sonia María Gagioti^{3,4}, Estela Bevilacqua⁴. 1.Unidad de Investigación Médica en Epidemiología Clínica, Chihuahua, México. 2.Universidad Autónoma de Chihuahua, México. 3.Dept Histología y Embriología, Universidad São Paulo, Brasil. 4.Depto Morfología, Universidade Santo Amaro, Brasil

P-31

STRESS BY SLEEP DEPRIVATION DURING EARLY PREGNANCY INDUCES MISCARRIAGE

Eliana Lippe¹, Katsumasa Hoshino¹, Áureo T. Yamada². 1-Dept. Biologia, Fac. Ciências, UNESP, Bauru, SP, 2-Dept. Histologia e Embriologia, IB, UNICAMP, Campinas, SP.

PLACENTAL PATHOLOGY

P-32

FISH AND NESTED-PCR VS CYTOGENETIC APPROACH IN FETAL AND EARLY SPONTANEOUS ABORTIONS MATERIAL: CORRELATION WITH PATHOLOGICAL FINDINGS

Andrea C. de Moraes^{a,b}, M M Souza^a, IDC G Silva^c, FRS Patrício^a. ^aDepartment of Pathology, Federal University of São Paulo, Brazil; ^bCentro Paulista of Fetal Medicine São Paulo, Brazil; ^cMolecular Laboratory, Department of Gynecology, Federal University of São Paulo, Brazil

P-33

CORRELATION BETWEEN THE PLACENTA AND THE LUNG IN HYALINE MEMBRANE DISEASE (HMD) USING IMMUNOCHEMISTRY AND DIGITAL IMAGE PROCESSING.

Antônio F. de S. Bezerra¹, Wellington P. dos Santos² and Ana Lúcia B. Candeias².

¹Pathology Dept, UNCISAL, Maceió, AL. ²DECart, UFPE, Brasil.

P-34

PLACENTOMEGALY AND FETAL MALFORMATION: CLINICO-PATHOLOGICAL FEATURES IN A CASE OF 2ND TRIMESTER ABORTION

Márcia M Souza^{a, b}; Andréa C. Moraes^a; ECNC Silva^b; FRS Patrício^a. ^aDept Pathology, Federal University of São Paulo, ^bGrajau Hospital

P-35

FOCUSING ON THE ANALYSIS OF THE PLACENTA AS A PREVENTIVE DIAGNOSTIC INVESTIGATION OF CONGENITAL TOXOPLASMOSIS

Maria Ophélia Araújo; A Simões-Barbosa; P. Carvalho; E Chaves; L Coutinho; P Gontijo; J. Jacques; R Oliveira; D Sasaki; A Iunes. Universidade Católica de Brasília

P-36

ICAM-1 IS OVER-EXPRESSED IN VILLOUS TROPHOBLAST IN PLACENTITIS

Priscila B. Juliano¹; Blotta, M.H.S.; Altemani, A.M.A.¹. ¹Departamento de Anatomia Patológica, UNICAMP, Campinas, Brasil; ²Departamento de Patologia Clínica, UNICAMP, Campinas, Brasil.

P-37

THE TROPHOBLAST BARRIER IS IMPORTANT ON MODULATION OF VILLITIS CAUSED BY PARASITES

Priscila B. Juliano¹; Blotta, M.H.S.; Altemani, A.M.A.¹. ¹Departamento de Anatomia Patológica, UNICAMP, Campinas, Brasil; ²Departamento de Patologia Clínica, UNICAMP, Campinas, Brasil.

P-38

CHORANGIOMA, CHORANGIOMATOSIS, CHORANGIOSIS AND MESENCHYMAL DYSPLASIA OF THE PLACENTA - AN IMMUNOHISTOCHEMICAL INVESTIGATION

Regina Schultz; Sheila AC Siqueira; Neila A Souza; Venâncio AF Alves. Divisão de Anatomia Patológica e LIM 14, HC FMUSP – São Paulo – Brasil

PLACENTAL TRANSPORT

P-39

CALCIUM TRANSPORT AND SELF-INHIBITION BY POLYCYSTIN-2 IN HUMAN SYNCYTIOTROPHOBLAST

Gustavo A. Timpanaro, Nicolás Montalbetti, Horacio F. Cantiello & Silvia González Perrett. Laboratorio de Canales Iónicos, Facultades de Farmacia y Bioquímica y de Medicina, Univ. de Buenos Aires, Argentina. Massachusetts General Hospital East, Charlestown, MA, USA.

P-40**CALCIUM CHANNELS FROM HUMAN SYNCYTIOTROPHOBLAST BASAL MEMBRANE**

Loreta Bernucci and G Riquelme. Inst Ciencias Biomédicas, Facultad Medicina, U. Chile. Santiago, Chile.

P-41**CYTOSKELETAL CONTROL OF POTASSIUM TRANSPORT IN HUMAN SYNCYTIOTROPHOBLAST**

Nicolás Montalbetti, Gustavo A. Timpanaro, Silvia González Perrett, and Horacio F. Cantiello. Laboratorio de Canales Iónicos, Facultades de Farmacia y Bioquímica y de Medicina, Univ. de Buenos Aires, Argentina, and Massachusetts General Hospital East, Charlestown, MA, USA

P-42**IMMUNOHISTOCHEMICAL FOLLOW-UP OF HUMAN TROPHOBLAST MEMBRANE PROTEIN TRANSPLANTATION TO THE MEMBRANE OF XENOPUS OOCYTES**

Paula Díaz, M Henriquez and G Riquelme. Instituto de Ciencias Biomédicas. Facultad Medicina, U. de Chile. Santiago, Chile.

P-43**MODULATION OF MAXI Cl^- CHANNEL FROM HUMAN PLACENTA BY ANNEXIN VI**

Paula Llanos⁽¹⁾, G Barrientos⁽¹⁾, B Campos⁽²⁾ & G Riquelme⁽¹⁾. ⁽¹⁾Inst. Ciencias Biomédicas. Facultad Medicina, U. Chile. Santiago, Chile. ⁽²⁾College of Medicine, University of Cincinnati, USA

P-44**EXPRESSION OF APXL IN HUMAN PLACENTA**

Silvana del Mónaco^{1,2}, Alicia Damiano^{2,3}, Elsa Zotta², Cristina Ibarra^{2,3} and Basilio Kotsias¹
¹Lab. de Neurofisiología, Instituto A. Lanari, Fac. Medicina; ²Lab Fisiopatogenia, Depto Fisiología, Fac. Medicina; ³Lab. Canales Iónicos, Fac. Farmacia y Bioquímica, Universidad Buenos Aires, Argentina.

P-45**IS VDAC THE MOLECULAR CORRELATE OF THE APICAL MEMBRANE MAXI Cl^- CHANNEL FROM HUMAN PLACENTA?**

M Henríquez⁽¹⁾, Veronica Jimenez⁽¹⁾, JM González-Ros⁽²⁾ and G Riquelme⁽¹⁾ Instituto Ciencias Biomédicas. Facultad Medicina, U. Chile. Santiago, Chile⁽¹⁾; ⁽²⁾ Instituto Biología Molecular y Celular. U. Miguel Hernández. Elche, Spain.

PREGNANCY-ASSOCIATED DISEASES**P-46****MMP-3, MMP-7 AND TIMP-1 IN TERMINAL VILLI OF NORMAL, LUPUS AND PREECLAMPSIA HUMAN TERM PLACENTA**

Cássia Mônica de Oliveira Costa Rocha. State University of Rio de Janeiro, Rio de Janeiro, Brazil

P-47**ANTEPARTUM AND POSTPARTUM CA-ATPASE ACTIVITY AND LIPID PEROXIDATION IN PREECLAMPTIC WOMEN**

Cilia Abad, TT López, NJ Oviedo, T Proverbio, F Proverbio, R Marín. IVIC, CBB, Caracas, Venezuela

P-48**THROMBOMODULIN DEPLETION OF THE ENDOTHELIAL CELLS OF STEM VILLI ARTERIES CORRELATES WITH ELEVATED PLASMA PAI-1/PAI-2 RATIO IN PREECLAMPSIA**

Cleofina Bosco, P Barja, R Rodrigo, V Fernández, M Suárez, H Muñoz* and M Parra *. ICBM y Hospital Clínico* Facultad de Medicina, Universidad de Chile.

P-49**PLACENTAL WEIGHTS IN EXPERIMENTAL DIABETES AND HYPERTENSION**

Débora C Damasceno; Gustavo T Volpato; Renato Rocha; Iracema MP Calderon; José C Peraçoli; Marilza VC Rudge. Lab. Pesquisa Experimental Obstetrícia, Depto. Ginecologia e Obstetrícia, Faculdade de Medicina de Botucatu, UNESP.

P-50**LEVELS OF PPAR γ ACTIVATOR 15DEOXYDELTA^{12,14}PROSTAGLANDIN J₂ (15DPGJ₂) AND ITS EFFECT ON NITRIC OXIDE PRODUCTION IN PLACENTA FROM HEALTHY AND DIABETIC PATIENTS**

Elida Gonzalez¹, Evangelina Capobianco¹, Verónica White¹, Mario Baier², Susana Salzberg², Mario Pesaresi² & Alicia Jawerbaum². ¹Lab Reproduction & Metabolism, CEFYBO-CONICET; ²Obstetrics & Nutrition Depts. Carlos G Durand Hospital, Argentina.

P-51**TNF- α MATERNAL SERUM LEVELS AND PLACENTAL MORPHOLOGICAL ANALYSIS OF ANIMALS VACCINATED AGAINST YELLOW FEVER**

Fernanda Silva-1; Fernanda Magaldi-1; Bruna Galves-1; Sato, H.-2; Domingos, H.-1 & Bevilacqua, E.-1. 1-Instituto de Ciências Biomédicas, Universidade de São Paulo; 2-Centro de Vigilância Epidemiológica, Secretaria da Saúde – SP, Brasil.

P-52**TOXOPLASMA GONDII IN THE HUMAN CHORIOCARCINOMA CELLS LINE (BEWO)**

Juliana G. de Oliveira¹; José R. Mineo; Maria A. de Souza¹; Deise A. O. Silva¹; Eloisa A. V. Ferro². Laboratory of Immunology, Biomedical Science Institute, Univ Uberlândia, MG, Brazil. Lab Morphology, Biomedical Science Institute, Univ Uberlândia, M.G. Brazil.

P-53**PROSPECTIVE STUDY OF THE INFLUENCE IN THE PERINATAL OUTCOME OF THE WEIGHT, VOLUME, AND ABSOLUTE DENSITY OF PLACENTAS OF PREGNANT WOMEN WITH HIGH BLOOD PRESSURE OR DIABETES**

Marilza Vieira Cunha Rudge*; Ulisses Del Nero*; Maria Aparecida Mourão Brasil*; Iracema de Mattos Paranhos Calderon*; José Carlos Peraçoli*; Cibeli Vieira Cunha Rudge**. Faculdade de Medicina de Botucatu – UNESP, Brasil

P-54

ENDOTHELIAL DYSFUNCTION IN UMBILICAL VEIN ENDOTHELIAL CELLS FROM FOETUS WITH INTRAUTERINE GROWTH RESTRICTION IS RELATED TO CHRONIC HYPOXIA

^{1,2}Paola Casanello, ¹Luis Sobrevia. ¹Cellular and Molecular Physiology Laboratory (CMPL), Dept Obstetrics & Gynaecology, Medical Research Centre, School of Medicine, Pontificia Universidad Católica de Chile, Santiago, Chile. ²Dept of Obstetrics & Gynaecology, Faculty of Medicine, Universidad de Concepción, Concepción, Chile.

P-55

MORPHOLOGICAL AND COMPARATIVE STUDY ON THE CHORIONIC VILLI OF THE HUMAN PLACENTA AT TERM IN NORMAL AND PREECLAMPSIA PATIENTS

Rachel E Santos; Ana LP Quinto; Roberta C Perosa; Silvia HS Côrtes; João CS Côrtes Jr; João CS Côrtes. Department of Histology and Embryology (USS), Vassouras, RJ.

P-56

DOPPLER VELOCIMETRY OF MATERNAL UTERINE ARTERIES AND PLACENTAL BED HISTOLOGY IN PREECLAMPSIA

Regina ALP Aguiar¹; Antônio Carlos V Cabral¹; Ana Maria A Lana². ¹Depto Ginecologia e Obstetrícia, Faculdade de Medicina - Universidade Federal de Minas Gerais, MG, Brasil; ²Depto Anatomia Patológica e Medicina Legal, Faculdade de Medicina da Universidade Federal de Minas Gerais, MG, Brasil

P-57

MORPHOLOGIC PLACENTAL ALTERATION AND ITS CORRELATION WITH HYPERTENSIVE DISORDERS DURING PREGNANCY

Rosana Rosa Miranda Correa; Aline Santa Cruz Belela; Marina Carvalho Paschoin; Mara Lúcia Fonseca Ferraz; Vicente Paula Antunes Teixeira; Marlene Antônia Reis; Eumenia Costa da Cunha Castro. Disciplina de Patologia Geral, Departamento de Ciências Biológicas da Faculdade de Medicina do Triângulo Mineiro.

REGULATORY MOLECULES AT MATERNAL -FETAL INTERFACE

P-58

INSULIN LIKE GROWTH FACTOR I (IGF-I), STEROIDS HORMONES AND METABOLIC PROFILE IN PIG PREGNANCY.

Ramiro Martínez & Adriana Vivas. Department of Animal Anatomy, Agronomic and Veterinary Faculty. National University of Rio Cuarto. Argentina. Route 36 km 601. PC: X5804BYA. ☎ 54-358-4676210.

P-59

DETECTION OF EARLY PREGNANCY FACTOR (EPF) IN PORCINE PLACENTA CONDITIONED MEDIUM (PPCM) BY MAMMALS POLYCLONAL ANTIBODIES (pAbs)

Carolina Grosso¹; Cecilia Greco¹; Rudiger Schade²; Adriana Vivas¹. ¹Animal Anatomy, Immunology. Universidad Nacional de Río Cuarto, Ruta Nac 36 Km 601 (X5804BYA) Argentina, ²Institute Charite, Humbolt University – Berlin, ☎+54-358-4676210

P-60

OVARIAN IMMUNE AND ENDOCRINE SYSTEMS IN THE POLYCYSTIC OVARY SYNDROME in pregnant and non-pregnant mice

Valeria Sander¹, Carolina Griselda Luchetti¹, Claudio Gonzalez², Guillermo Di Girolamo², Sara Chicchio³, Graciela Cremaschi¹, Alicia B Motta¹ - ¹Centro de Estudios Farmacológicos y Botánicos, Consejo de Investigaciones Científicas y Tecnológicas, Argentina. ²Facultad Medicina, Depto Farmacología, ³Instituto de Neurobiología, Argentina

P-61

EXPRESSION AND ACTIVITY OF PROTEINS INVOLVED IN CHOLESTEROL METABOLISM IN CYTOTROPHOBLAST AND SYNCYTIOTROPHOBLAST CELLS OF HUMAN TERM PLACENTA

Annie Duchesne, A Montoudis, J Simoneau and Lafond. Laboratoire de Physiologie Materno-Fœtal, Université du Québec à Montréal, Mtl., Canada H3C 3P8.

P-62

CHARACTERIZATION OF MELATONIN RECEPTOR, MT1 AND MT2, IN HUMAN PLACENTA

Cathy Vaillancourt^{1,2}, Madeleine Arsenault¹ and Jason Roussel¹. ¹Dept Chemistry & Biochemistry, Université de Moncton & ²Beauséjour Medical Research Institute, Moncton, New Brunswick, Canada.

P-63

EPIDERMAL GROWTH FACTOR MODULATION OF PROSTAGLANDINS AND NITRITE BIOSYNTHESIS IN RAT FETAL MEMBRANES

Cella Maximiliano, Farina Mariana, Ogando Diego, Ribeiro María, Franchi Ana. Laboratorio de Fisiopatología de la Preñez y el Parto (CEFYO, CONICET), Argentina.

P-64

IFN- γ MODULATES THE EXPRESSION OF INDUCIBLE NITRIC OXIDE SYNTHASE IN MOUSE ECTOPLACENTAL CONE CELLS

Eduardo C Leanza & E Bevilacqua. Dept Histology and Embryology, Institute of Biomedical Sciences, University of São Paulo, SP-Brazil.

P-65

FUNCTIONS OF 11 β -HYDROXYSTEROID DEHYDROGENASE TYPE 1 AND 2 IN HUMAN PLACENTA AND FETAL MEMBRANES

Kang Sun^{1,2}, Ping He¹, Shunlun Wan¹, Leslie Myatt². ¹Dept Physiology, The Second Military Medical Univ, P.R.China. ²Dept Obstetrics & Gynecology, Univ Cincinnati, Cincinnati, USA

P-66

IDENTIFICATION OF VITAMIN D RECEPTOR AND ITS UPREGULATION BY 1,25(OH)₂D₃ BEFORE CABP28K EXPRESSION UPREGULATION IN JEG-3 CHORIOCARCINOMA CELL LINE

Louiza Belkacemi, Lucie Simoneau & Julie Lafond. Laboratoire de Physiologie Materno-foetale, Département des Sciences Biologiques, Université du Québec à Montréal, Montréal, Québec, Canada.

P-67

LOCALIZATION AND REGULATION OF CALBINDIN-D28k (CaBP28k) EXPRESSION IN JEG-3 HUMAN CHORIOCARCINOMA CELLS

Louiza Belkacemi¹, Deni Flipo², Lucie Simoneau¹ & Julie Lafond¹ ¹Laboratoire de Physiologie Materno-foetale, ²Centre Toxen, Département des Sciences Biologiques, Université du Québec à Montréal, Montréal, Québec, Canada.

P-68

MOUSE ECTOPLACENTAL CONE CELLS EXPRESS MRNA OF THE IFN- γ -INDUCIBLE PROTEINS IP-10 AND GBP2 IN A SIMILAR MANNER TO THAT OF MACROPHAGES

Mara S Hoshida; EC Leanza; S Gagioti and E Bevilacqua. Dept Histology and Embryology, Institute of Biomedical Sciences, University of São Paulo – SP Brazil.

P-69

ROLE OF EPIDERMAL GROWTH FACTOR ON THE MODULATION OF CYCLOOXYGENASE AND NITRIC OXIDE SYNTHASE ENZYMES IN THE PLACENTA

María Laura Ribeiro, Mariana Farina, Ana Franchi. Laboratorio de Fisiopatología de la Preñez y el Parto (CEFYBO, CONICET) Argentina.

P-70

HUMAN INTERFERON GAMMA (IFN- γ) ALTERS THE EXPRESSION OF PERLECAN IN MOUSE EMBRYOS “IN VITRO”

Virginia Choren¹, Vanina Fontana¹, Lucrecia Calvo¹, Juan C. Calvo², Mónica Cameo¹, ¹Biología de la Reproducción. Ecuador 1465 (1425). Bs.As.Argentina. ²IBYME-CONICET, BID-1201/OC-AR N^o05-03511

P-71

CYTOKINE GENES POLYMORPHISMS AND RECURRENT SPONTANEOUS ABORTION

Renate von Linsingen¹, Eni Picchioni-Bompeixe¹ and Maria da Graça Bicalho¹. ¹Federal University of Paraná, Genetics Department, Curitiba, Brazil.

UTERINE NK CELLS

P-72

ISOLATION AND CULTURE OF MOUSE UTERINE NATURAL KILLER CELLS

Aline Macedo, Márcia C. Bizinotto, Valdemar A. Paffaro Jr., Wirla Tamashiro, Áureo T. Yamada. Depto. Histologia e Embriologia, IB, UNICAMP, 13083-970, Campinas, SP, Brazil

P-73

EMBRYONIC LESION INDUCES RELEASE OF CYTOLYTIC CONTENT FROM GRANULES OF UNK CELLS

Cecilia Copi, Paulo P. Joazeiro, Aureo T. Yamada. Department of Histology and Embryology, IB, UNICAMP – Campinas, SP, Brasil

P-74

EFFECTS OF GLYCOSAMINOGLYCANS ON NK AND T CELL POPULATIONS IN MURINE PREGNANCY

Julio Bueno² and Angela Cadavid. Group of Reproduction, School of Medicine, University of Antioquia, Medellín-Colombia.

P-75**IDENTIFICATION OF MOUSE UTERINE NK CELLS SPECIFIC MOLECULES**

Marcia C Bizinotto⁽¹⁾; Wirla MSC Tamashiro⁽²⁾; Áureo T Yamada⁽¹⁾. (1) Dept. Histology & Embriology, IB/UNICAMP (2) Dept. Microbiology & Immunology, IB/UNICAMP, Campinas-SP Brazil.

P-76**ADHESION MOLECULES ON MOUSE UNK CELLS AND THE DISTRIBUTION OF THEIR LIGANDS DURING PREGNANCY**

Valdemar A. Paffaro Jr., Paulo P Joazeiro, Áureo T Yamada. LCI/DHE/IB -UNICAMP. 13083-970, Campinas. SP. Brazil.

Poster Session *AUTHOR INDEX*

- Abad, C. 23
Aguiar, R.A.L.P. 24
Aisemberg, J. 19, 20
Albano, R.M. 20
Albuquerque, F.T. ... 19
Altemani, A.M.A. 22
Alves, V.A.F. 22
Amarante-Paffaro, A. 17
Andrade, C.G.T.J. ... 19
Antonini, S. 18
Araújo, M.O. 21
Arsenault, M. 25
Baier, M. 23
Barbisan, L.F. 17
Barja, P. 23
Barreto Filho, J.B. ... 19
Barrientos, G. 22
Behringer, R. 20
Belela, A.S.C. 24
Belizário, J.E. 17
Belkacemi, L. 26
Bernucci, L. 22
Bevilacqua, E. 17, 18, 19, 21, 24, 25, 26
Bezerra, A. F.S. 21
Bianco, J.E.R. 19
Bicalho, M.G. 26
Bizinotto, M.C. 27
Blanchon, L. 21
Blotta, M.H.S. 22
Bocco, J.L. 21
Bonattelli, M. 19
Bosco, C. 23
Brasil, M.A.M. 17, 18, 24
Bueno, J. 18, 27
Cabral, A.C.V. 24
Cadavid, A. 18, 27
Cadavid, L. 18
Calderon, I.M.P. 17, 18, 23, 24
Calvo, J.C. 26
Calvo, L. 26
Camargo, L.S.A. 19
Cameo, M. 26
Campos, B. 22
Candeias, A.L.B. 21
Candeloro, L. 20
Cantiello, H.F. 22
Capobianco, E. 23
Caraveo-Borunda, E. 20
Carbone, K. 20
Carvalho, P. 21
Carvalho, P.H. A. ... 19
Carvalho, R.G. 19
Casanello, P. 24
Castro, E.C.C. 24
Cavalcanti, V. 19
Cella, M. 19, 20, 25
Chaves, E. 21
Chávez, D. 21
Chicchio, S. 25
Choren, V. 26
Copi, C. 27
Cordeiro, L.A.V. 18
Correa, R.R.M. 24
Corrêa, S.T. 17
Côrtes Jr., J.C.S. 18, 24
Côrtes, J.C.S. 18, 24
Côrtes, S.H.S. 18, 24
Costa, E.C.N.F. 17
Costa, R.A.A. 18
Coutinho, L. 21
Couto, G. P. 19
Couto, M.C.A. 19
Cremaschi, G. 25
Cuello, F. 18
Damasceno, D.C. ... 23
Damiano, A.E. 23
Del Mónaco, S. 23
Del Nero, U. 18, 24
Di Girolamo, G. 25
Díaz, P. 22
Domingos, H. 24
Duchesne, A. 25
Farina, M. 25, 26
Favero, D. 19
Fernández, V. 23
Ferraz, M.L.F. 24
Ferreira de Sá, V. ... 19
Ferreira, A. M. 19
Ferreira, I.C.M. 19
Ferro, E.A.V. 24
Figueiredo, A.L.S. ... 20
Flipo, D. 26
Fohn, L. 20
Fontana, V. 26
Franchi, A. 19, 20, 25, 26
Frank, H. 18
Galves, B.V. 24
Gagiotti, S.M. 19, 21, 26
Genta, F.A. 19
Gomes, S.M.Z. 17
Gonçalves, C.R. 18
Gontijo, P. 21
González, C. 17, 25
Gonzalez, E. 23
González-Horta, C. 20
González-Puebla, E. 20
González-Ros, J.M. 23
Greco, C. 18, 25
Grosso, C. 25
Guzmán, C. 18
He, P. 26
Henríquez, M. 22, 23
Hoshida, M.S. 26
Hoshino, K. 21
Ibarra, C. 23
Islas, K. 17
Iunes, A. 21
Jacques, J. 21
Jawerbaum, A. 23
Jimenez, V. 23
Joazeiro, P.P. 19, 27
Juliano, P.B. 22
Kadirov, M. 18
Kaufmann, P. 18
Kotsias, B. 23
Lafond, J. 25, 26
Lana, A.M.A. 24
Leanza, E.C. 25, 26
Levario-Carrillo, M. 17, 21
Lima, R.S.P. 18
Lippe, E. 21
Llanos, P. 22
López, T.T. 23
López-Díaz, F. 21
Luchetti, C.G. 25
Macedo, A. 27
Machado-Santelli, G. 18
Magaldi, F.M. 24
Marín, R. 23
Martinez, R. 25
Miglino, M.A. 19
Minazaki, C.K. 19
Mineo, J.R. 24
Miqueloto, C. 19
Montalbetti, N. 22
Montoudis, A. 25
Montoya, F. 18
Moraes, A.C. 21
Moraes, S.G. 19
Motta, A.B. 25
Muñoz, H. 23
Myatt, L. 26
Nores, R. 21
Novo, N.F. 18
Ogando, D. 19, 20, 25
Olave, M.E. 21

| | | | | | |
|-----------------------------|-------|--------------------------|-------------|--------------------------|----------|
| Oliveira, J.G. | 24 | Riquelme, G. | 22,23 | Sordo, M. | 17 |
| Oliveira, R. | 21 | Rocha, C.M.O.C. | 23 | Soto-Suazo, M. | 19 |
| Oliveira, S.F. | 19 | Rocha, R. | 23 | Souza, M.A. | 24 |
| Oviedo, N.J. | 23 | Rodrigo, R. | 23 | Souza, M.M. | 21 |
| Paffaro Jr., V.A. | 27 | Roussel, J. | 25 | Souza, N.A. | 22 |
| Panzetta-Dutari, G. | 21 | Rudge, C.V.C. | 24 | Spira, B. | 17 |
| Parra, M. | 23 | Rudge, M.V.C. | 17,18,23,24 | Stumpf, W.E. | 19 |
| Paschoin, M.C. | 24 | Salzberg, S. | 23 | Suárez, M. | 23 |
| Patrício, F.R.S. | 21 | San Martín, S. | 20 | Sun, K. | 26 |
| Patrito, L. | 21 | Sánchez-Ramírez, B. | 20 | Tamashiro, W. | 27 |
| Pellegrini, C. | 19,20 | Sander, V. | 25 | Teixeira, V.P.A. | 24 |
| Peña, B. | 18 | Sanin, L.H. | 20 | Terra, W. | 19 |
| Peraçoli, J.C. | 23,24 | Santos, R.E. | 18,24 | Timpanaro, G.A. | 22 |
| Perosa, R.C. | 18,24 | Santos, W.P. | 21 | Toledo, O.M. | 19 |
| Perrett, S.G. | 22 | Sapin, V. | 21 | Vaillancourt, C. | 25 |
| Pesaresi, M. | 23 | Sasaki, D. | 21 | Vale Filho, V. R. | 19 |
| Picchioni-Bompeixe, E. | 26 | Sato, H. | 24 | Vianna-Morgante, A. | 18 |
| Pinheiro, M.C. | 19 | Schade, R. | 25 | Vidsiunas, A.K. | 19 |
| Porto, L.C.M.S. | 20 | Schultz, R. | 22 | Vivas, A. | 18,25 |
| Proverbio, F. | 23 | Sgarbosa, F. | 17 | Volpato, G.T. | 23 |
| Proverbio, T. | 23 | Silva, D.A.O. | 24 | von Linsingen, R. | 26 |
| Queiroz, G.S. | 17 | Silva, E.C.N.C. | 21 | Wan, S. | 26 |
| Quinto, A.L.P. | 18,24 | Silva, F.C. | 24 | White, V. | 23 |
| Ramhorst, R. | 17 | Silva, I.D.C.G. | 21 | Wolff, P. | 17 |
| Ramos, A.A. | 19 | Simões-Barbosa, A. | 21 | Yamada, A.T. | 19,21,27 |
| Ramos-Martínez, E. | 20 | Simoneau, J. | 25 | Zago, D.A. | 19 |
| Reis, M.A. | 24 | Simoneau, L. | 26 | Zorn, T.M.T. | 19,20 |
| Reyes, E. | 17 | Siqueira, S.A.C. | 22 | Zotta, E. | 23 |
| Ribeiro, M.L. | 25,26 | Sobrevia, L. | 24 | | |